



ALUMAT-Frey GmbH
87600 Kaufbeuren
Im Hart 10

phone no.: 0 83 41 /47 25
 fax no.: 0 83 41 / 7 42 19
 e-mail: info@alumat.de
 website: www.alumat.de

domestic and foreign patents

MFAT 10

Magnetic double seal

With silicone seal

Thermally broken

For wood external doors

Absolutely barrier-free

System ALUMAT

Entrance - terrace - balcony - conservatory

(Revolving doors/turn and tilt doors/single-wing/double-wing/lap-jointed doors
 with fixed-glazing side parts)

- New construction profile
 No door stop, thus no stumbling blocks/threshold
- Suitable for wheelchairs
- Suited for homes for disabled people, hospitals,
 retirement homes, kindergartens, homes,
 residential buildings
- No mechanism
 No wear and tear
- Also for outward opening doors
- 20-year warranty on magnetic drag
- Subject to the new energy saving regulation
 with four-fold sealing
- Wall and threshold insulation up to 150 mm
 pursuant to German Flat Roof Guidelines and
 DIN 18195 Part.5, Section 8, 1, 5
 is **optionally** provided for
- Double thermal insulation

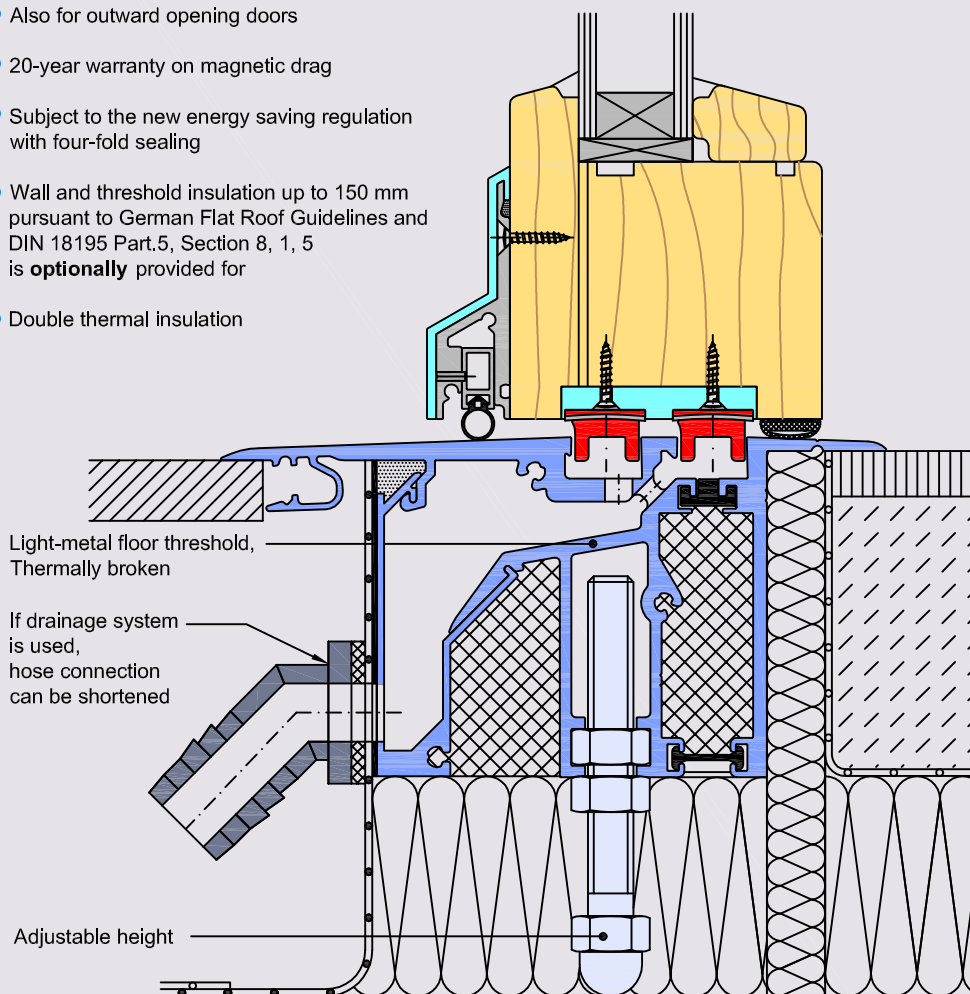

Stress group 9A pursuant to DIN 18055
Driving-rain-proof up to 100 metre floor-to-floor height
(also lap-jointed doors) Assessed soundproofing measure
R'_{Theta} w=43 dB

Included in delivery MFAT 10

The magnetic threshold is cut and delivered in fixed sizes to outside measurement of the door frame

optionally, yet not included in usual delivery:

Fittings for terrace sealing, factory-fitted on the threshold with planned sealing (150 mm) to the masonry pursuant to all professional rules

Wolfen tailored blank profiles and welded-on Wolfen sealing sheet, colour black d=150 mm, sheet width 550 mm, as well as two unpacked Wolfen external corners

Other plastic sealing strips, e.g. on the basis of PVC-pnb, EVA-PVC, FPO/TPO, chlorinated polyethylene, EPDM are available

- ① Aluminium weatherboard with profile cover, surface EV1 silver, bronze C 33 or white RAL 9016 or blank
- ② Plastic magnetic carrier profile 7 x 42.5 mm
- ③ Magnetic sealing profiles with insulation and double adhesive tape
- ④ adjustable silicone seal with weatherboard, two 5 x 6 mm set screws for invisible fixing with threaded holes
- ⑤ Aluminium ground profile **with thermal break and double thermal insulation** EV1 anodized, with protection film, drainage holes, as well as two magnetic sealing profiles with notch, always to be mounted pointing outward
- ⑥ Water reservoir with 17 mm holes as water outlet
- ⑦ 2 drainage nozzles for hose connection by the customer, Adding 4 self-cutting tapping screws 3.9x25 mm (for lap-jointed doors with 3 drainage nozzles)
- ⑧ Optional sealing sheet welded on by the manufacturer, connection bitumen compatible or identical to sealing material, respectively
- ⑨ height-adjustable distance screw M10 with adjusting nut and locknut
- ⑩ additional EPDM-sealing with special adhesive tape for durable fixing

* Measurements approx. 16 mm rebate at approx. 18 mm plus 2 mm

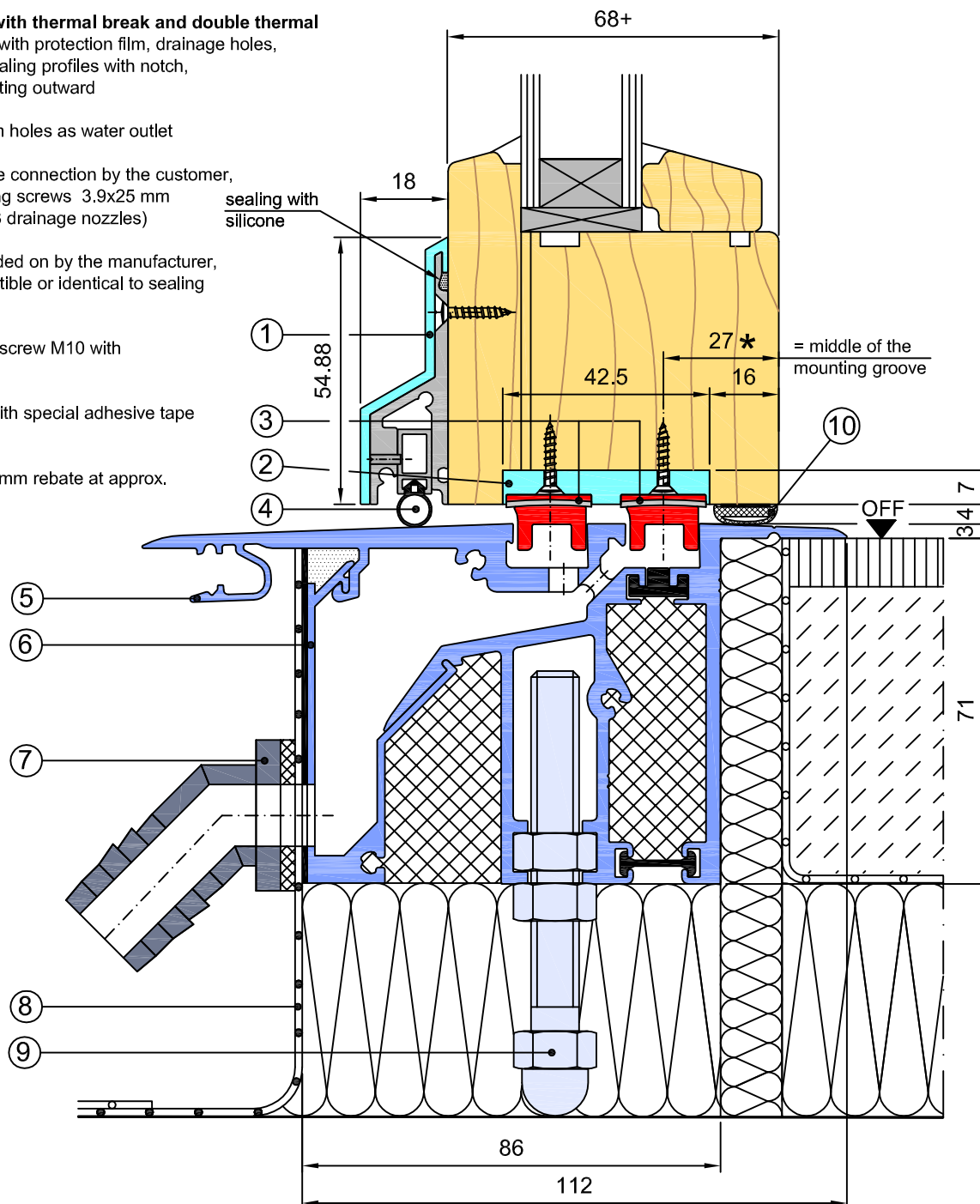

Holes for drainage are provided by the manufacturer, hose connection is not required

Further included in the delivery:

- (a) two plastic clip profiles white RAL 9016 and brown RAL 8019 for frontal weatherboard cover
- (b) two aluminium profiles cover against soiling of the magnetic channels
- (c) two plastic profiles inserts 15x9x50 mm with holes and screws for fixing 4,0x25 mm for lap-jointed doors (to choose from)
- (d) two plastic fastening plates with sealing predrilled and slit for mounting the wall sealings by the customer and the manufacturer, respectively
Alternatively, can be cut from (d) by the customer
- (e) two moulded plastic adaptors for 68 mm door frame
- (f) two plastic profiles for masonry sealing

Plastic adaptor profile white RAL 9016 or brown RAL 8016
For fixed-glazing side parts and door frames
Can be adjusted in breadth

Assembly C profile to bypass of
thermally insulated wall constructions

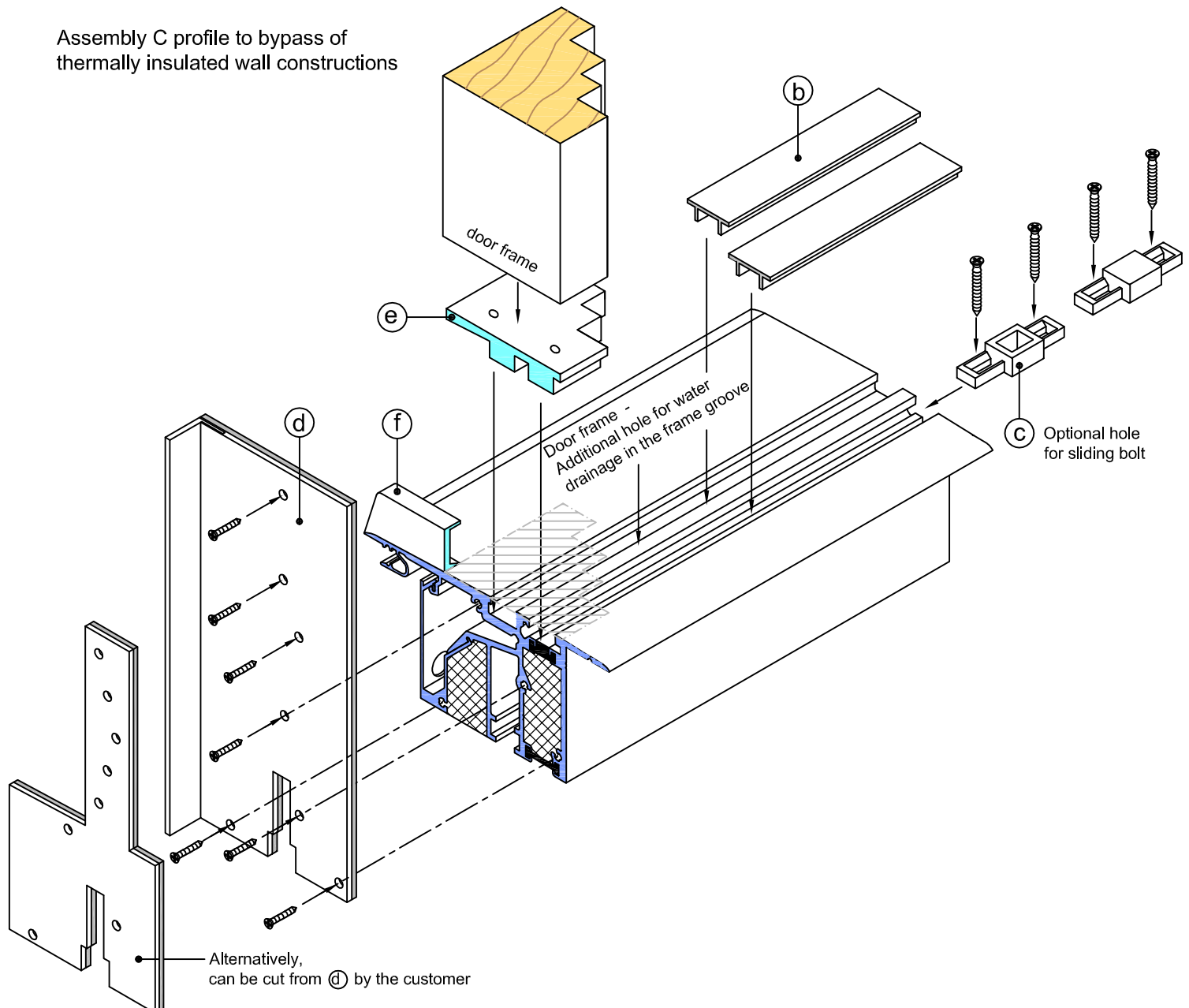
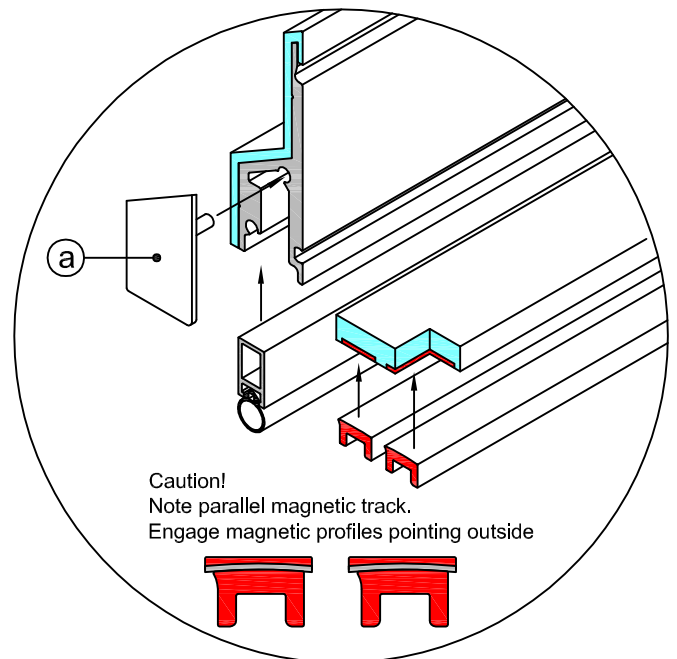

Threshold Sealing and Processing by the manufacturer

Model Alumat MFAT 10

(in compliance with German flat roof guidelines and DIN 18195 Part 5 Section 8.1.5)

Fittings for terrace sealing on the threshold, pre-assembled by the manufacturer with provided Sealing (150 mm) to the masonry, available against surcharge

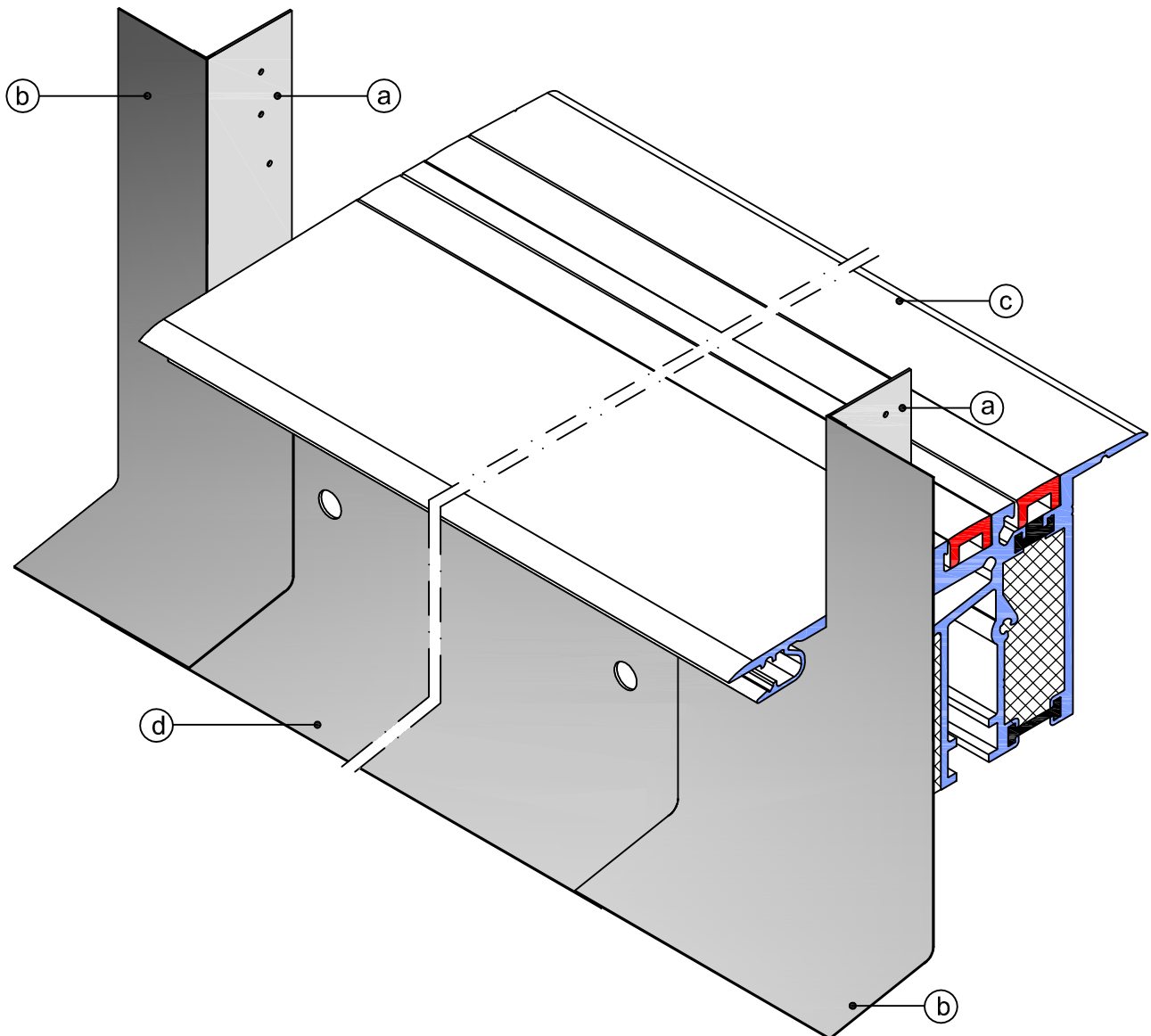

- (a) Plastic assembly plates predrilled and slit
- (b) Wolfin-sealing sheet, welded with tailored blanks by the manufacturer
- (c) Aluminium ground profile
- (d) Wolfin sealing strip, tailored waterproof to the predrilled water reservoir by means of tailored blanks

Alumat Frey GmbH
Im Hart 10
87600 Kaufbeuren

phone no.: 08341-4725
fax no.: 08341-74219

email: info@alumat.de
website: www.alumat.de